

CONSTANT PRESSURE ELECTRIC WATER HEATERS

Long life, high performance and reliable service have been hallmarks of Beasley products for more than 50 years. There are many models to meet your needs for both domestic and commercial applications.

CEILING MODELS 5 and 5P

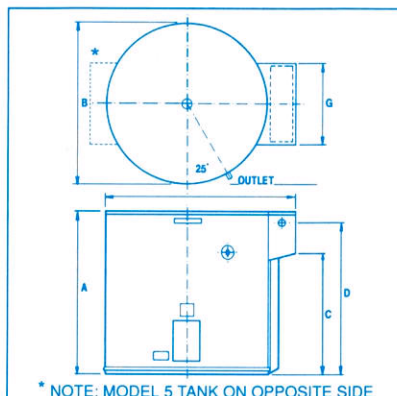
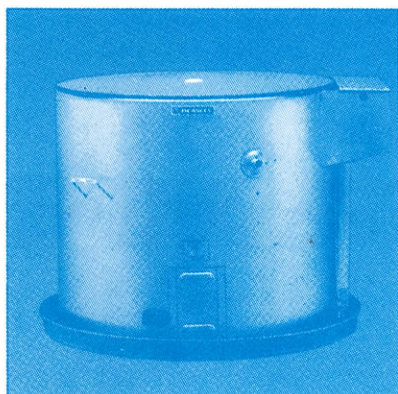

WATER HEATER NOMINAL DIMENSIONS	MODEL 5			MODEL 5P	
Rated Delivery litres	160	250	315	250	315
A Ht. mm	520	720	900	765	900
B Dia. mm	865	865	865	875	875
C Ht. mm	335	410	525	560	700
D Dia. mm	490	690	870	735	870
E Ht. mm	1025	1025	1025	1035	1035
F Dia. mm	910	910	910	920	920
G Width mm	455	455	455	455	455
Approx. Weight kg	32	38	43	38	43
Element Wattage	2400	3000	3600	3000	3600

Features:

Beasley Model 5 heaters have established the term 'squat' heater, due to their low overall height and superior storage capacity.

The Model 5 range has a long life, quality copper storage tank with an incoloy immersion element and is specially designed for use with low cost off-peak electricity.

The Model 5P has all the features of the Model 5 except that the storage tank is made from heat stabilized rigid polypropylene which resists corrosive liquids better than most metals and is particularly suitable for areas where hard water is common.

Both Models 5 and 5P heaters are provided with the unique Beasley polypropylene drip tray and are complete with a cold water feed tank and float control valve.

FLOOR MODEL 7

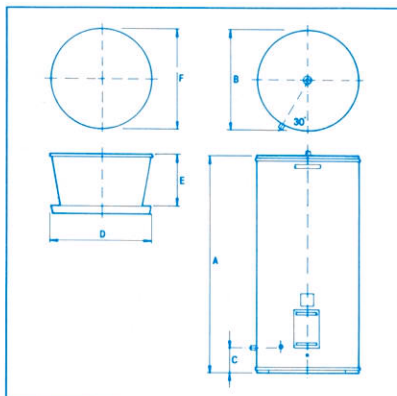
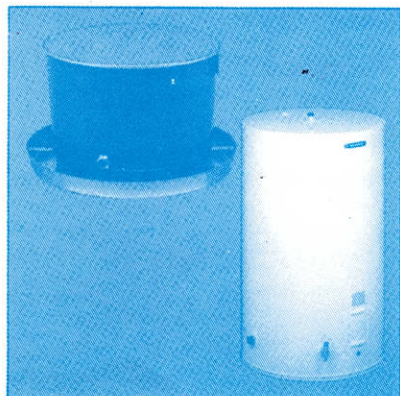

WATER HEATER NOMINAL DIMENSIONS				
Rated Delivery litres	160	250	250T	315
A Ht. mm	1415	1170	2015	1380
B Diam. mm	533	710	533	710
C Ht. mm	115	145	115	145
D Diam. mm	695	695	695	695
E Ht. mm	350	350	350	350
F Diam. mm	585	585	585	585
Cold Supply Tank Capacity litre	80	80	80	80
Approx. Weight kg	30	41	45	46
Element Wattage	2400	3000	3000	3600

Features:

Beasley Model 7 heaters can be installed either on the floor or in the ceiling. All units can be provided with weather proofing suitable for exterior installation.

The Model 7 is supplied complete with a separate feed tank. A balanced feed tank can be ordered as an option, providing constant pressure hot and cold water to the shower with no temperature fluctuations.

The Model 7 range has a long life quality copper storage tank with an incoloy immersion element and is specially designed for use with low cost off-peak electricity.

UNDERSINK MODEL 13

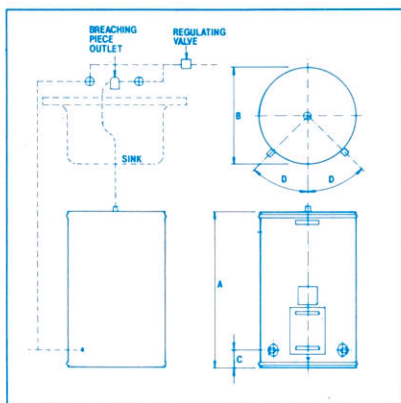

WATER HEATER NOMINAL DIMENSIONS

Rated Delivery litres	9	18	25
A Ht. mm	360	450	600
B Diam. mm	305	405	405
C Ht. mm	62.5	85	85
D Degrees	59	47	47
Approx. Weight kg	7	11	13
Element Wattage	1200	1200	1200

Features:

The Model 13 heater is designed for concealed installation under the sink to provide hot water for domestic kitchen use. Undersink units are especially suitable for:

1. Kitchens where the major hot water system is installed a long way from the kitchen.
2. Where hot water is used for speciality areas, for example School Laboratories and Commercial Premises where hot water is required only at the sink.

This unit is designed to supply hot water only to a **single** outlet such as a kitchen sink.

WARNING

The Model 13 is designed for mains pressure water to be connected to the cold water inlet via the stopcock which controls the cold water flow to the inlet side of the water heater. The regulating valve as supplied **MUST** be fitted in an accessible position (preferably on the outside wall) prior to both hot and cold control taps to balance the water flow at the breaching piece outlet. **DO NOT** connect direct to mains pressure supply.

ABOVE SINK MODEL 9A

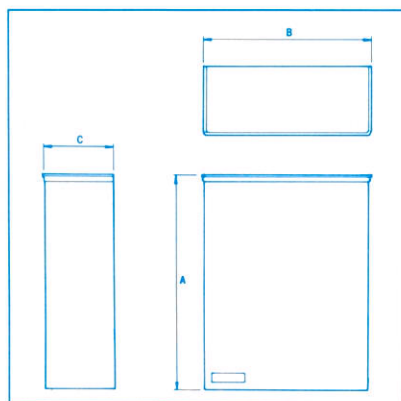
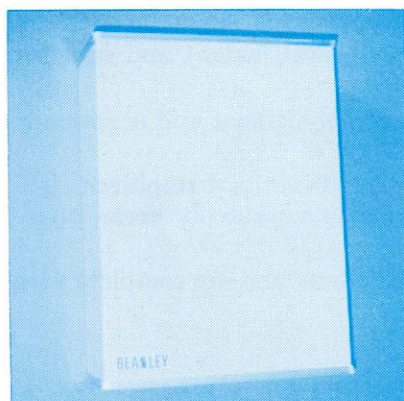

WATER HEATER NOMINAL DIMENSIONS

Rated Delivery litres	8
A Ht. mm	432
B Width mm	311
C Depth	156
Approx. Weight kg (full)	14.6
Element Wattage (Watts)	750

Features:

The Model 9A heater is designed for above sink installations to provide hot water for domestic kitchen use.

Above sink heaters are especially suitable for:

1. Kitchens where the major hot water system is installed a long way from the kitchen.
2. Where hot water is required in speciality areas such as School Laboratories and commercial premises where hot water is required only at the sink.

WARNING

Clamp-on appliances such as mobile dishwashers or washing machines **MUST NOT** be operated from Beasley UNDERSINK or ABOVE SINK hot water systems.

DISTRIBUTED BY:



BEASLEY
HOT WATER SYSTEMS

DESIGNED AND MANUFACTURED IN AUSTRALIA
EXPORT ENQUIRIES TO:
BEASLEY INDUSTRIES PTY. LTD.
Devon Park, S.A. 5008
Telephone: (08) 340 2299 International: 618 340 2299
Fax: (08) 340 0829 International: 618 340 0829